

SIGN	DATE	DESCRIPTION	APPROVER
		THIS IS CAD DRAWING, DO NOT REVISE MANUALLY!!!	

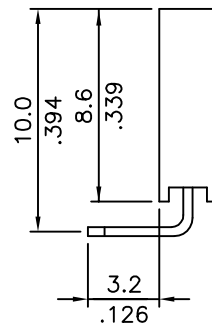
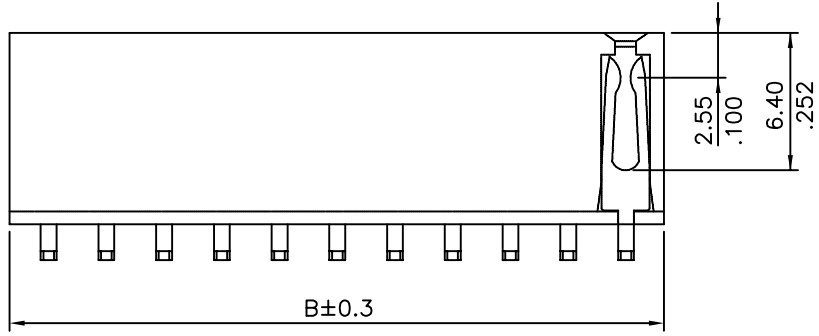
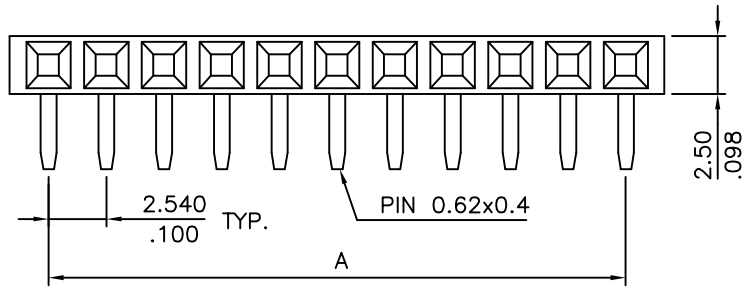

- Material:
- Insulator: Glass Filled Polyester, UL94V-0
 - Color: Black
 - Contacts: Brass
 - Contact plating: Flash Gold over 50u" Nickel
other options may require MOQ

- Electrical:
- Current: 3A Max.
 - Voltage: 250V AC(r.m.s.)
 - Insulation Resistance: >1000 MΩ
 - Contact Resistance: <20mΩ
 - Dielectric Voltage: 1000VAC/minute
 - Operating Temperature: -40°C ~ +105°C
- RoHS Compliant

Part Number

SH3-XXG

↑
of circuits

A = 2.54 * (No. of Circuits - 1)
B = A + 3.0
* Available in 2 through 40 circuits

DIM.A TOLERANCE	
2P~19P	±0.20
20P~40P	±0.35

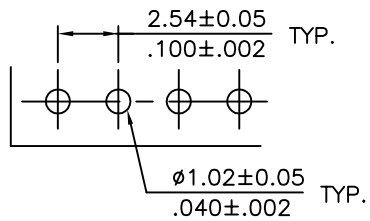

Recommended P.C. Board Layout

Contact OST for more options

TITLE				SH3 Series, 2.54mm, single row female header, right angle			
PART NO.		SH3-XXG		DWG NO.		SH3-XXG.DWG	
APPROVED	CHECKED	DESIGNED	DRAWN	4050		Tolerance	
Shi Jun 2007.01.22	Marvin 2007.01.22	Marvin 2007.01.22	Marvin 2007.01.22			UNIT: mm/inches	
SHEET: 01/01		REV.: A				X.X ±0.30/.012	
						X.XXX ±0.10/.004	
						X* ±1°	

THESE DRAWINGS AND SPECIFICATIONS ARE THE PROPERTY OF ON-SHORE TECHNOLOGY, INC. AND SHALL NOT BE REPRODUCED, COPIED OR USED IN ANY MANNER WITHOUT THE PRIOR WRITTEN CONSENT OF ON-SHORE TECHNOLOGY, INC.