

| | | | |
|---|------|-------------|----------|
| SIGN | DATE | DESCRIPTION | APPROVER |
| | | | |
| <i>THIS IS CAD DRAWING, DO NOT REVISE MANUALLY!!!</i> | | | |

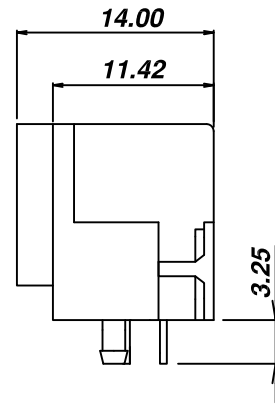
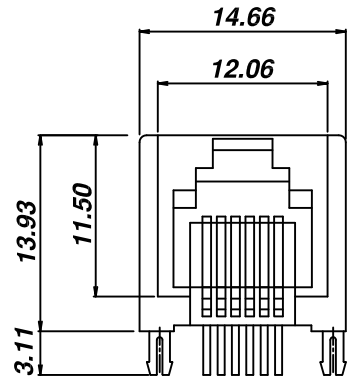

Material:

- Housing: PBT Glass Filled (UL 94V-0)
- Color: Black
- Spring Wire: 0.45mm Diameter Phosphor Bronze
Gold Plating over Nickel
- Temp. Range: -40°C/+85°C
- Durability: 500 Mating cycles Min.

Electrical:

- Current rating: 1.5A Max.
- Voltage rating: 120V AC
- Insulation Resistance: >500 MΩ
- Contact Resistance: <20mΩ
- Dielectric Voltage: 1,000 Vrms for 60 sec. min.

RoHS Compliant

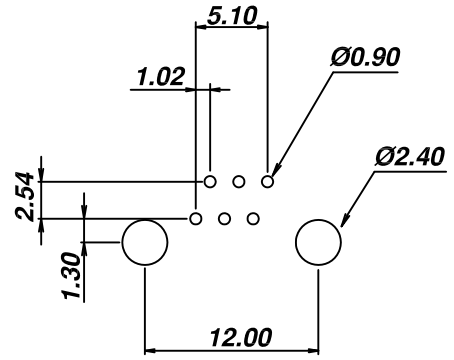

**PCB Layout
(Top View)**

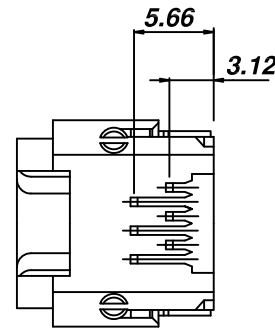

● Part Number

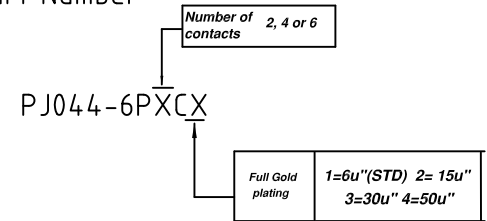

Non STD may require MOQ



THESE DRAWINGS AND SPECIFICATIONS ARE THE PROPERTY OF ON-SHORE TECHNOLOGY, INC. AND SHALL NOT BE REPRODUCED, COPIED OR USED IN ANY MANNER WITHOUT THE PRIOR WRITTEN CONSENT OF ON-SHORE TECHNOLOGY, INC.

| | | | | | | | |
|---------------------|---------------------|---|----------------------|----------|-----------|-----------------|-------------|
| TITLE | | PJ044 Series - 6 pos, 2, 4 or 6 cont, side entry, thru hole | | | | | |
| PART NO. | | PJ044-6PXCX | | DWG NO. | | PJ044-6PXCX.DWG | |
| APPROVED | CHECKED | DESIGNED | DRAWN | CUST NO. | Tolerance | | |
| Billy 2008.07.01 | Johnn 2008.07.01 | Tony 2008.07.01 | Steven 2008.07.01 | | | UNIT: mm | X.XX ±0.25 |
| | | | | | | SCALE: NONE | X.XXX ±0.13 |
| SHEET: 01/01 | | | | | REV: A | X.XXXX ±0.05 | |