

SIGN	DATE	DESCRIPTION	APPROVER
THIS IS CAD DRAWING, DO NOT REVISE MANUALLY!!!			

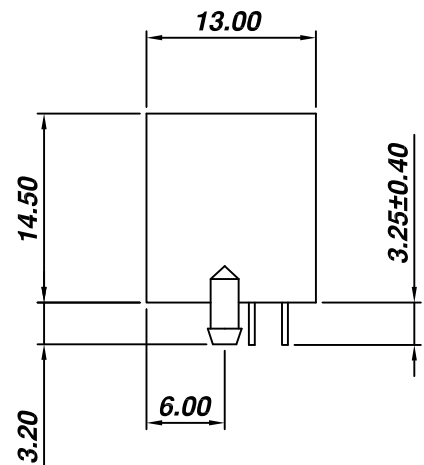

- Material:**
- Housing: PBT Glass Filled (UL 94V-0)
  - Color: Black
  - Spring Wire: 0.45mm Diameter Phosphor Bronze Gold Plating over Nickel
  - Temp. Range: -40°C/+85°C
  - Durability: 500 Mating cycles Min.
- Electrical:**
- Current rating: 1.5A Max.
  - Voltage rating: 120V AC
  - Insulation Resistance: >500 MΩ
  - Contact Resistance: <20mΩ
  - Dielectric Voltage: 1,000 Vrms for 60 sec. min.
- RoHS Compliant

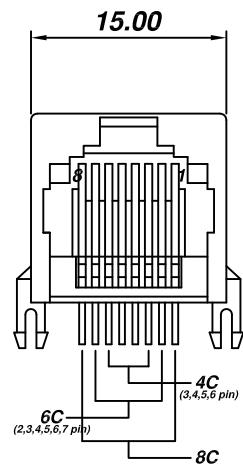
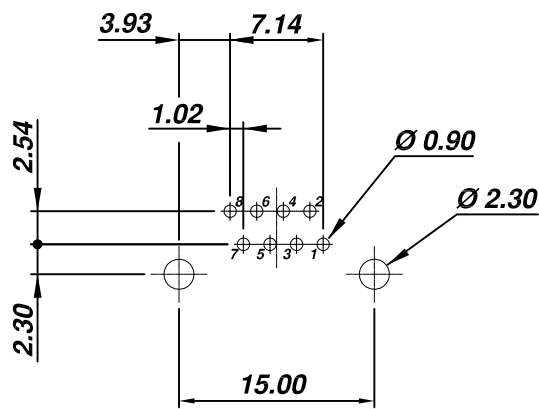

**PCB LAYOUT  
(Top View)**

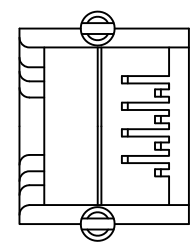

● Part Number

Number of contacts 2, 4, 6 or 8

PJ026-8PXCX

Full Gold plating

1=6u"(STD) 2= 15u"  
3=30u" 4=50u"

add -G for Gray color at end of p/n

Non STD may require MOQ

THESE DRAWINGS AND SPECIFICATIONS ARE THE PROPERTY OF ON-SHORE TECHNOLOGY, INC. AND SHALL NOT BE REPRODUCED, COPIED OR USED IN ANY MANNER WITHOUT THE PRIOR WRITTEN CONSENT OF ON-SHORE TECHNOLOGY, INC.



TITLE		PJ026 Series - 8 pos, 2, 4, 6 or 8 conf, side entry, thru hole, mini low profile					
PART NO.		PJ026-8PXCX		DWG NO.		PJ026-8PXCX.DWG	
APPROVED		CHECKED	DESIGNED	DRAWN	CUST NO.		Tolerance
Billy 2008.07.01		Johnn 2008.07.01	Tony 2008.07.01	Steven 2008.07.01			X.XX ±0.25 X.XXX ±0.13 X.XXXX ±0.05
				SHEET: 01/01		UNIT: mm SCALE: NONE REV: A	