

SIGN	DATE	DESCRIPTION	APPROVER
		THIS IS CAD DRAWING, DO NOT REVISE MANUALLY!!!	

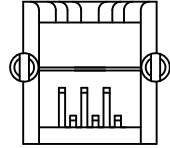

- Material:**
- Housing: PBT Glass Filled (UL 94V-0)
  - Color: Black
  - Spring Wire: 0.45mm Diameter Phosphor Bronze Gold Plating over Nickel
  - Temp. Range: -40°C/+85°C
  - Durability: 500 Mating cycles Min.
- Electrical:**
- Current rating: 1.5A Max.
  - Voltage rating: 120V AC
  - Insulation Resistance: >500 MΩ
  - Contact Resistance: <20mΩ
  - Dielectric Voltage: 1,000 Vrms for 60 sec. min.
- RoHS Compliant

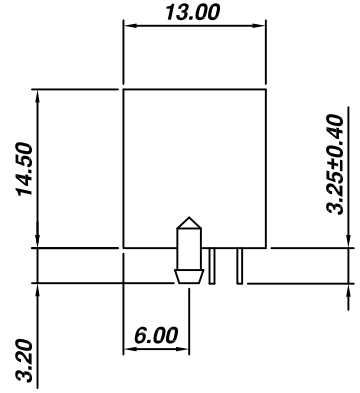
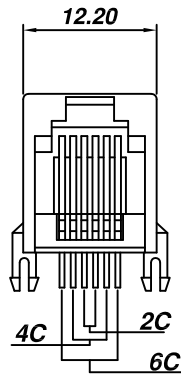
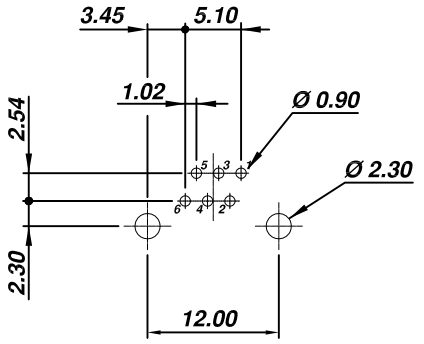

**PCB LAYOUT**  
**(Top View)**

● Part Number

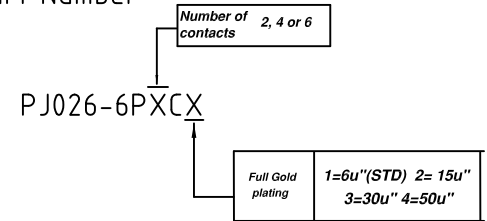

add -G for Gray color at end of p/n  
Non STD may require MOQ

THESE DRAWINGS AND SPECIFICATIONS ARE THE PROPERTY OF ON-SHORE TECHNOLOGY, INC. AND SHALL NOT BE REPRODUCED, COPIED OR USED IN ANY MANNER WITHOUT THE PRIOR WRITTEN CONSENT OF ON-SHORE TECHNOLOGY, INC.

<b>OST</b> ON-SHORE TECHNOLOGY, INC.									
TITLE PJ026 Series - 6 pos, 2, 4 or 6 cont, side entry, thru hole, mini low profile									
PART NO. PJ026-6PXCX			DWG NO. PJ026-6PXCX.DWG						
APPROVED	CHECKED	DESIGNED	DRAWN	CUST NO.	Tolerance				
Billy 2008.07.01	Johnn 2008.07.01	Tony 2008.07.01	Steven 2008.07.01		UNIT: mm		X.XX ±0.25		
				SHEET: 01/01		SCALE: NONE		X.XXX ±0.13	
						REV.: A		X.XXXX ±0.05	