

SIGN	DATE	DESCRIPTION	APPROVER
		<i>THIS IS CAD DRAWING, DO NOT REVISE MANUALLY!!!</i>	

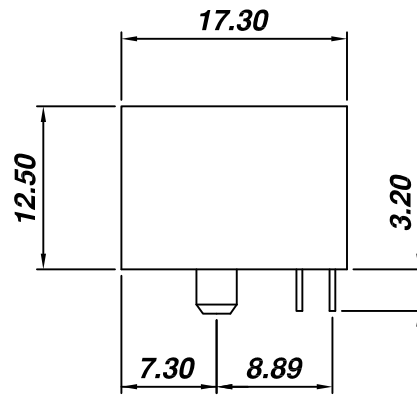
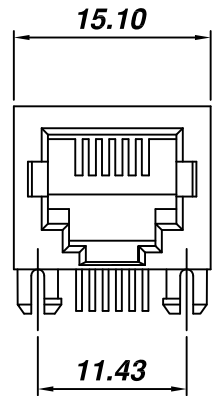

**Material:**

- Housing: PBT Glass Filled (UL 94V-0)
- Color: Black
- Spring Wire: 0.45mm Diameter Phosphor Bronze Gold Plating over Nickel
- Temp. Range: -40°C/+85°C
- Durability: 500 Mating cycles Min.

**Electrical:**

- Current rating: 1.5A Max.
- Voltage rating: 120V AC
- Insulation Resistance: >500 MΩ
- Contact Resistance: <20mΩ
- Dielectric Voltage: 1,000 Vrms for 60 sec. min.

RoHS Compliant

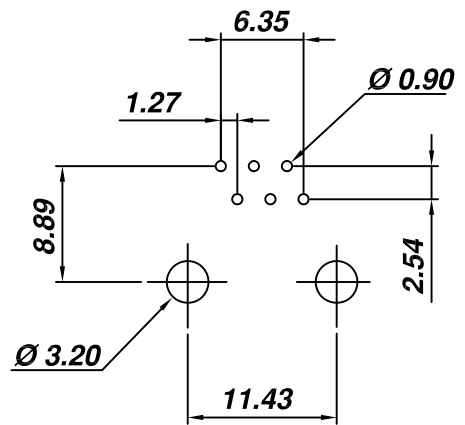

**PCB LAYOUT  
( Top View )**

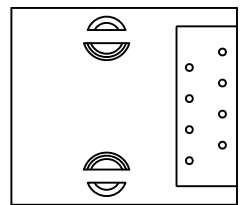

● Part Number

No. of contacts: 2, 4, or 6

PJ022-6PXCX

Full Gold plating	1=6u"(STD) 2= 15u" 3=30u" 4=50u"
Selective Gold plating	6=6u"(STD) 7= 15u" 8=30u" 9=50u"

Non STD may require MOQ

THESE DRAWINGS AND SPECIFICATIONS ARE THE PROPERTY OF ON-SHORE TECHNOLOGY, INC. AND SHALL NOT BE REPRODUCED, COPIED OR USED IN ANY MANNER WITHOUT THE PRIOR WRITTEN CONSENT OF ON-SHORE TECHNOLOGY, INC.



TITLE		PJ022 Series - 6 pos, 2, 4 or 6 cont, side entry, thru hole				
PART NO.		PJ022-6PXCX		DWG NO.		PJ022-6PXCX.DWG
APPROVED	CHECKED	DESIGNED	DRAWN	CUST NO.		Tolerance
Billy 2005.01.12	Johnn 2005.01.12	Tony 2005.01.12	Steven 2005.01.12			X.XX ±0.25 X.XXX ±0.13 X.XXXX ±0.05
				SHEET: 01/01		UNIT: mm SCALE: NONE REV: A