

SIGN	DATE	DESCRIPTION	APPROVER
THIS IS CAD DRAWING, DO NOT REVISE MANUALLY!!!			

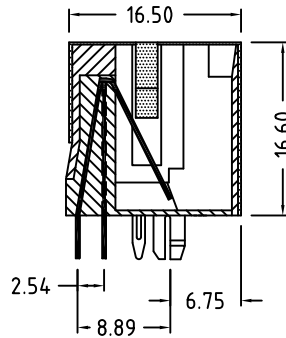
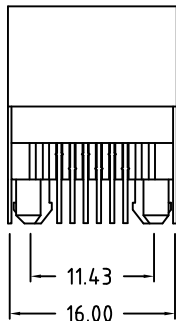
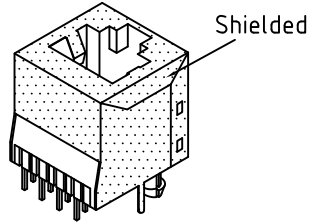
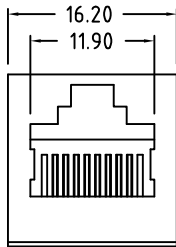

Material:

- Housing: PBT Glass Filled (UL 94V-0)
- Color: Black
- Spring Wire: 0.35mm Diameter Phosphor Bronze
Gold Plating over Nickel on contact area
Tin plated over Nickel on solder area
- Temp. Range: -40°C/+80°C
- Durability: 500 Mating cycles Min.

Electrical:

- Current rating: 1.5A Max.
- Voltage rating: 120V AC
- Insulation Resistance: >500 MΩ
- Contact Resistance: <30mΩ
- Dielectric Voltage: 1,000 Vrms for 60 sec. min.

RoHS Compliant

● Part Number

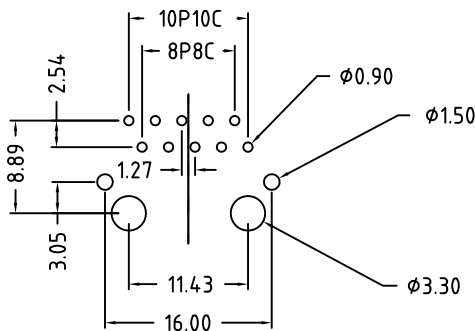
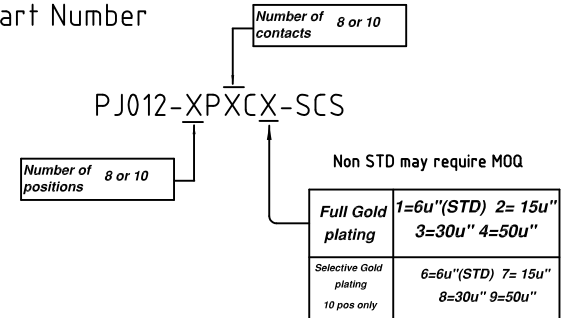

PCB LAYOUT / TOP VIEW

THESE DRAWINGS AND SPECIFICATIONS ARE THE PROPERTY OF ON-SHORE TECHNOLOGY, INC. AND SHALL NOT BE REPRODUCED, COPIED OR USED IN ANY MANNER WITHOUT THE PRIOR WRITTEN CONSENT OF ON-SHORE TECHNOLOGY, INC.

		TITLE				PJ012 Series - 8/10 pos, 8/10 cont, top entry, thru hole, shielded, center pin					
		PART NO.		PJ012-XPXCX-SCS		DWG NO.		PJ012-XPXCX-SCS.DWG			
APPROVED		CHECKED		DESIGNED		DRAWN		CUST NO.		Tolerance	
Billy 2007.04.10		John 2007.04.10		Tony 2007.04.10		Steven 2007.04.10				UNIT: mm SCALE: NONE X.XX ±0.25 X.XXX ±0.13 X.XXXX ±0.05	
SHEET: 01/01		REV: C									