

Recommended P.C.B Layout

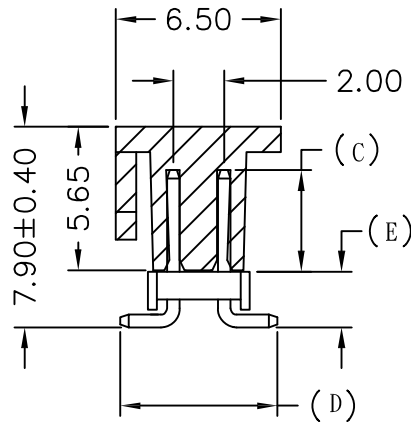

Option Code	Dimension		
	C	E	D
00	4.00	2.77	6.50
01	6.00	2.77	6.50
02	3.50	2.77	6.50
03	1.91	2.77	6.50
04	4.00	2.20	6.30

STANDARD

Contact OST for more options, MOQs may apply

MATERIAL  
Contact Pin: Brass  
Housing: Nylon 6T

SPECIFICATION  
Current Rating: 1 AMP  
Insulation Resistance: 5000MΩ Min. at DC 500V  
Contact Resistance: 20mΩ Max. at DC 100mA  
Dielectric Voltage: AC 500V for one minute

RoHS Compliant

PLATING:  
1: Flash Gold over Nickel (STD)  
5: Tin over Nickel  
7: Selective 15u" Gold over Nickel  
8: Selective 30u" Gold over Nickel  
non STD may require MOQ

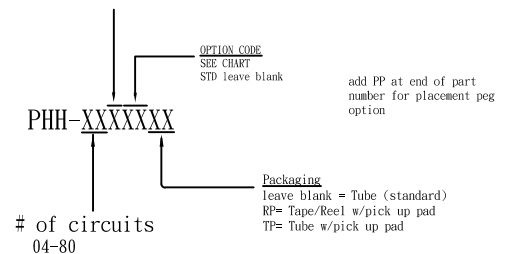

ON-SHORE TECHNOLOGY, INC.

APPD.  
DWG. HELEN  
DATE 2018/09/25

SCALE 参考  
UNIT mm  
PAGE 1 OF 1

TOLERANCE  
.0 ±0.35  
.00 ±0.25  
.000 ±  
ANG. ±5°  
SIZE.  
REV. A

PART NAME  
2.0mm PIN HEADER DUAL ROWS  
SMT TYPE H=1.5mm GOLD FLASH PLATING  
PART NO. PHH-XXXXXX