

SIGN	DATE	DESCRIPTION	APPROVER
		THIS IS CAD DRAWING, DO NOT REVISE MANUALLY!!!	

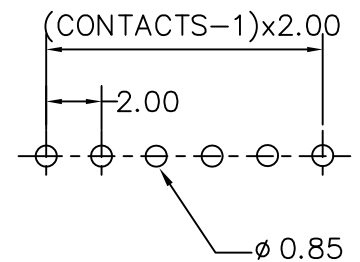

RECOMMENDED P.C.B LAYOUT

- Material:
- Insulator: Glass Filled Polyester, UL94V-0
 - Color: Black
 - Contact: Brass
- Electrical:
- Current: 1A Max.
 - Voltage: 250V AC(r.m.s.)
 - Insulation Resistance: >1000 MΩ
 - Contact Resistance: <20mΩ
 - Dielectric Voltage: 1000VAC/minute
 - Operating Temperature: -40°C ~ +105°C

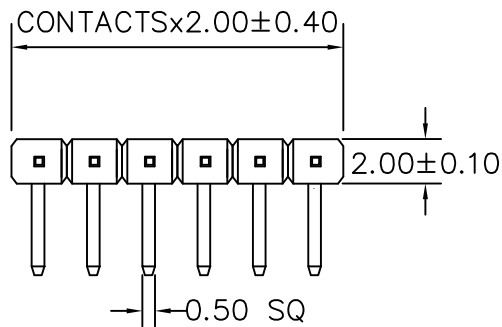
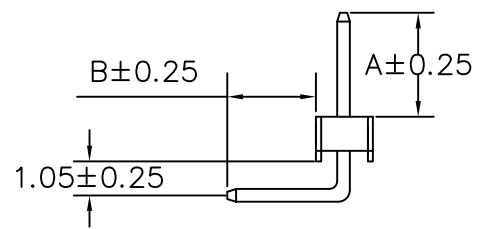
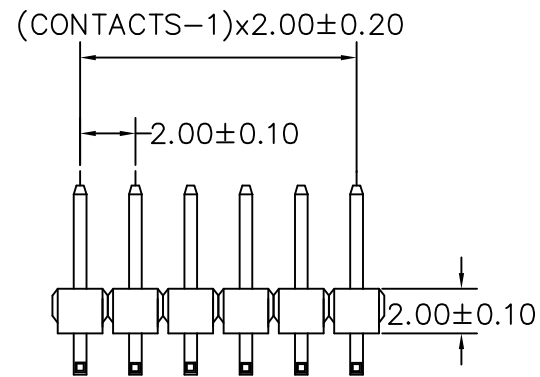

Part Number

OPTION CODE - leave blank for standard
SEE CHART

PHC-XX1XX

of circuits

PLATING:

- 1: Gold Flash/50u Nickel (STD)
- 5: 120u" Tin/30u" Nickel
- 7: 15u" Gold/50u" Nickel
- 8: 30u" Gold/50u" Nickel

non STD may require MOQ

Pin Length Option Chart

Option Code	Dimensions		STANDARD
	A	B	
00	4.00(.157)	2.80(.110)	
01	3.00(.118)	2.80(.110)	
02			
03			

Non standard may require mins. Consult factory for more options

RoHS Compliant



THESE DRAWINGS AND SPECIFICATIONS ARE THE PROPERTY OF ON-SHORE TECHNOLOGY, INC. AND SHALL NOT BE REPRODUCED, COPIED OR USED IN ANY MANNER WITHOUT THE PRIOR WRITTEN CONSENT OF ON-SHORE TECHNOLOGY, INC.

TITLE		PHC Series, 2.00mm, Single Row right angle male header			
PART NO.	PHC-XX1XX	DWG NO.	PHC.DWG		
APPROVED	CHECKED	DESIGNED	DRAWN	1200	
Shi Jun 2006.01.24	Marvin 2006.01.24	Marvin 2006.01.24	Marvin 2006.01.24	Tolerance	
				UNIT: mm	X.X ±0.30
				SCALE: NONE	X.XXX ±0.20
				REV: A	X* ±0.10
				SHEET: 01/01	X° ±1°