

Transfer or duplication of this document as well as the utilisation or communication of its content are not permitted unless express consent is granted. Violations give rise to claims for damages. All rights reserved in case of patent, utility model or design patent registrations.

Technical Data:
 Electrical
 Pitch: 5.00mm
 Voltage rating: 300V
 Current rating: 16 Amps
 Withstanding Voltage: 1600VAC(1min) Test time=60sec/1pcs
 Insulation resistance: 500MΩ or more at DC500V
 Contact resistance: ≤5mΩ
 Mechanical:
 Operating temperature: -40°C to +105°C
 Soldering temperature
 Temperature= 250°C ± 10°C/ 5 seconds max
 Safety approval: 
 RoHS Compliance

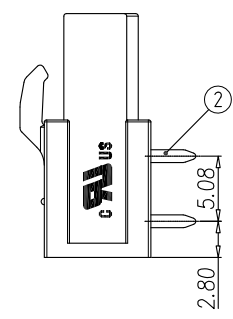
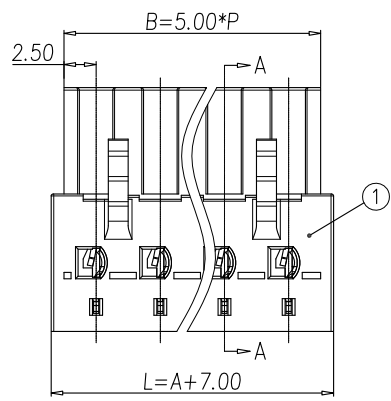
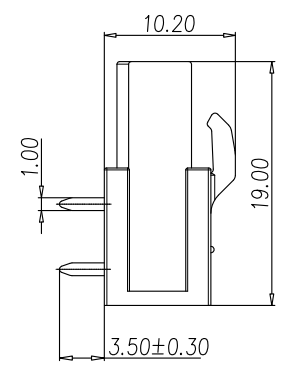
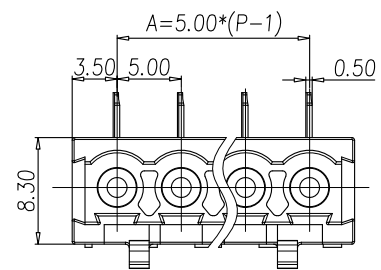
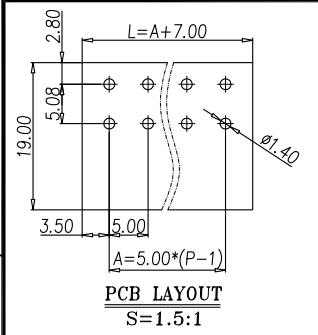

Part No:
OSTV7XX7151

No. of Poles	COLOR
02 2 Poles	0: Black
03 3 Poles	2: Red
...	3: Orange
24 24 Poles	4: Yellow
	5: Green (Standard)
	6: Blue
	8: Grey

Nonstandard colors
Mins could apply

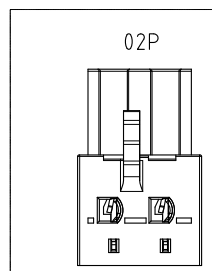

Total Pitch Tolerances in mm										Nominal dimension range in mm																			
over 0	over 30	over 53	over 70	over 90	over 115	over 150	over 200	over 250	over 300	over 0	over 30	over 53	over 70	over 90	over 115	over 150	over 200	over 250	over 300	over 0	over 30	over 53	over 70	over 90	over 115	over 150	over 200	over 250	over 300
to 30	to 53	to 70	to 90	to 115	to 150	to 200	to 250	to 320	to 30	to 30	to 53	to 70	to 90	to 115	to 150	to 200	to 250	to 320	to 30	to 0	to 30	to 53	to 70	to 90	to 115	to 150	to 200	to 250	to 320
±0.20	±0.25	±0.3	±0.35	±0.4	±0.55	±0.70	±0.85	±1.00	±0.25	±0.30	±0.35	±0.4	±0.55	±0.70	±0.80	±0.90	±1.20	±1.20	±0.25	±0.30	±0.35	±0.4	±0.55	±0.70	±0.80	±0.90	±1.20	±1.20	±0.25

REV	△	SIGN	DESCRIPTION	CHK.	DATE

2	Contact	Copper Alloy	Tin plated	1xN
1	Body	PA66 UL94V-0		1
ITEM	NAME OF PART	MATERIAL	NOTES	Q"TY
DWG.	JRT	DATE	2021.03.20	UNITS: MM
CHK.	DATE	SCALE:	NONE 3:1	REV.: A
APP.	DATE	TITLE:	OSTV7 SERIES 5.00MM	SEE CHART
		PART NO.	OSTV7XX7151	
		DWG NO.	OSTV7XX7151.DWG	



ON-SHORE TECHNOLOGY, INC.