

Transfer or duplication of this document as well as the utilisation or communication of its content are not permitted unless express consent is granted. Violations give rise to claims for damages. All rights reserved in case of patent, utility model or design patent registrations.

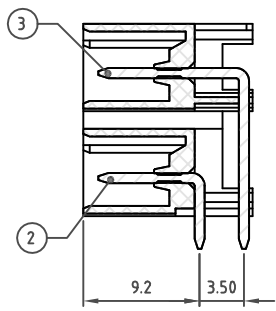
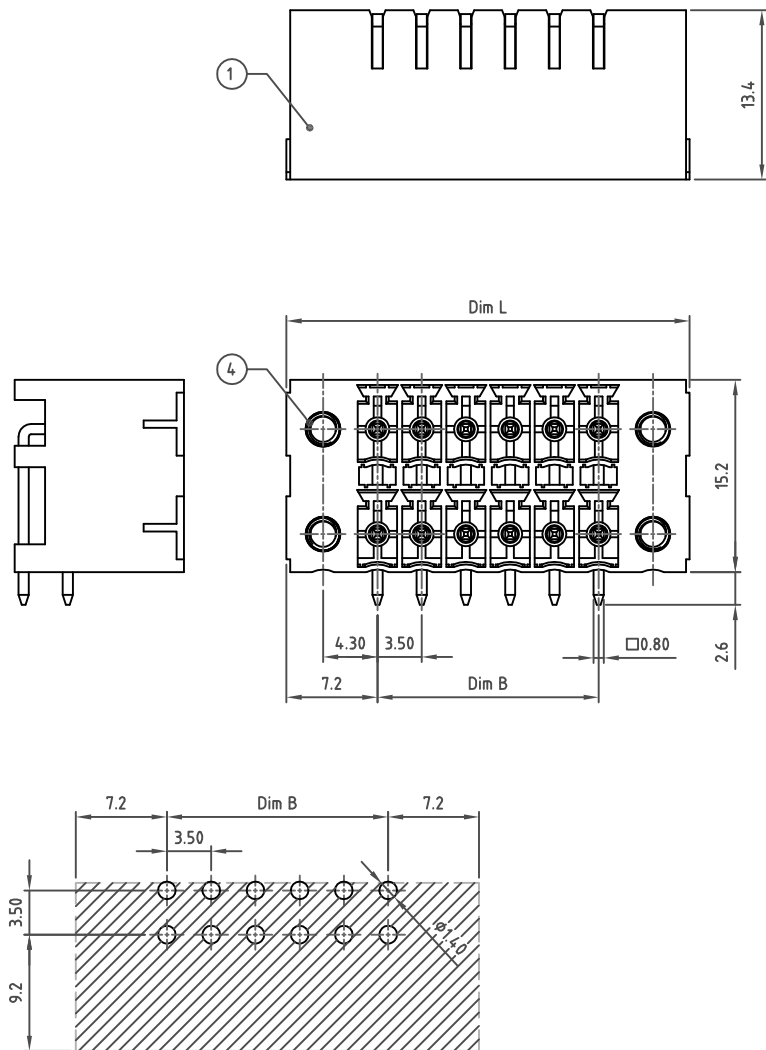

**Technical data**

- 1.Nominal voltage: 150V/8A  
PITCH:3.5mm
- 2.Insulation Withstanding Voltage:  
AC 1300V/MIN
- 3.Insulation Resistance:  
1000MΩ or more at DC500V
- 4.Flange tightening torque:  
3.0kgf.cm (0.3N.m)
- 5.Flange screw thread: M2.5
- 6.Operating temperature range:-40°C ~ 115°C
- 7.Undimensioned Tolerances:

Dim.L=(P-1)×3.5+14.4		
Dim.B=(P-1)×3.5		
P=1/2 Number of poles (04-48P)		
0-30mm	Dim B	Dim L
over 30mm-60mm	±0.15	±0.20
over 60mm-90mm	±0.20	±0.25
over 90mm	±0.25	±0.30
	±0.30	±0.40

- 8.Safety approval:
- 9.RoHS Compliance

Part No.: **OSTKEXX1251**

No. of Poles	COLOR
02 2 Poles	0: Black
03 3 Poles	2: Red
...	3: Orange
24 24 Poles	4: Yellow
	5: Green (Standard)
	6: Blue
	8: Grey

Nonstandard colors  
Mins could apply

4	Screw nut	BRASS		4
3	PIN 2	COPPER	TIN PLATED	1/2P
2	PIN 1	COPPER	TIN PLATED	1/2P
1	BODY	PA66 UL94V-0	ALL COLOR	1
ITEM	NAME OF PART	MATERIAL	NOTES	Q'TY
DWG.	WF. Zhang	DATE	2018.07.10	UNITS: MM SHEET: 1 OF 1 Tolerance
CHK.	WF. Zhang	DATE	2018.07.10	SCALE: NONE 2.5:1 ( : ) REV.: B X. ±0.50 X.X ±0.30 X.XX ±0.10 X° ±1°
APP.		DATE		TITLE: OSTKE3.5 Series W/flange type Right angle (90D)
				PART NO. OSTKEXX1251
				DWG NO. OSTKEXX1251.dwg

	Add NO MARK SPEC.	WF.Z	7/10'18
SIGN	DESCRIPTION	CHK.	DATE

**OST**  
ON-SHORE TECHNOLOGY, INC.