

SIGN	DATE	DESCRIPTION	APPROVER
THIS IS CAD DRAWING, DO NOT REVISE MANUALLY!!!			

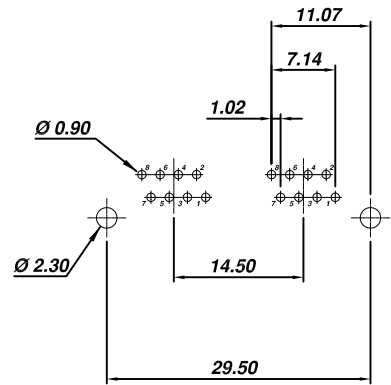
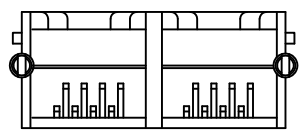
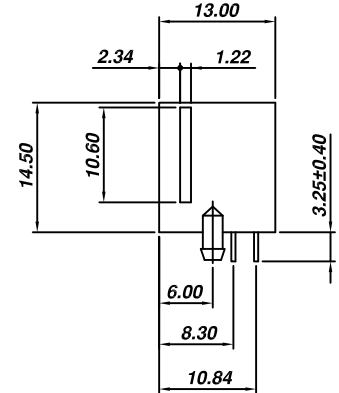
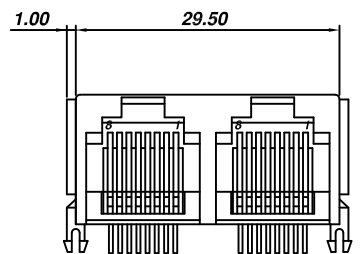

PCB LAYOUT
(Top View)

Material:

- Housing: PBT Glass Filled (UL 94V-0)
- Color: Black/Medium Gray
- Spring Wire: 0.45mm Diameter Phosphor Bronze
Gold Plating over Nickel
- Temp. Range: -40°C/+85°C
- Durability: 500 Mating cycles Min.

Electrical:

- Current rating: 1.5A Max.
- Voltage rating: 120V AC
- Insulation Resistance: 500 MΩ Min.
- Contact Resistance: 20mΩ Max.
- Dielectric Voltage: 1,000 Vrms for 60 sec. min.

Part Number:

GJ026-8P8CX2

-G for Gray

Gold plating	1=6u"	2=15u"	3=30u"	4=50u"
--------------	-------	--------	--------	--------

RoHS Compliant

THESE DRAWINGS AND SPECIFICATIONS ARE THE PROPERTY OF ON-SHORE TECHNOLOGY, INC. AND SHALL NOT BE REPRODUCED, COPIED OR USED IN ANY MANNER WITHOUT THE PRIOR WRITTEN CONSENT OF ON-SHORE TECHNOLOGY, INC.



TITLE		GJ026, 8 pos, 8 cont, side entry, thru hole, dual port			
PART NO.	GJ026-8P8CX2	DWG NO.	GJ026-8P8CX2.DWG		
APPROVED	CHECKED	DESIGNED	DRAWN	CUST NO.	Tolerance
Billy 2006.02.07	John 2006.02.07	Tony 2006.02.07	Steven 2006.02.07		UNIT: mm
					SHEET: 01/01
				SCALE: NONE	REV: A