

DIM	P	2	3	4	5	6	7	8	9	10	11	12
L		25.7	40.2	54.7	69.2	83.7	98.2	112.7	127.2	141.7	156.2	170.7
TOL (±)		0.08	0.12	0.16	0.20	0.24	0.28	0.32	0.36	0.40	0.44	0.48



THESE DRAWINGS AND SPECIFICATIONS ARE THE PROPERTY OF ON-SHORE TECHNOLOGY, INC. AND SHALL NOT BE REPRODUCED, COPIED OR USED IN ANY MANNER WITHOUT THE PRIOR WRITTEN CONSENT OF ON-SHORE TECHNOLOGY, INC.

SIGN	DATE	DESCRIPTION	APPROVER
△	07.26.2012	Added mounting hole diameter	

THIS IS CAD DRAWING, DO NOT REVISE MANUALLY!!!

NOTES:

- Rating: 300V 65A(UL)
- Insulation Withstanding Voltage: AC2000V/MIN
- Insulation Resistance: $\geq 500M\Omega$ or more at DC500V
- Temperature Range: $-33^{\circ}C/+105^{\circ}C$
- Screw Torque Vlaue: 17.5lbf-in(UL)
- Wire Range: 6-18AWG
- Housing: Nylon PA66, UL94-V0
- Screw M5, Steel, Zinc Plated
- Standard Color: Natural

Agency Approvals:  

RoHS Compliant

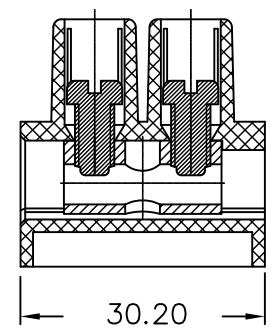

TITLE		ES1450 Series - 14.5mm Euro Strip, flat base			
PART NO.	ES1450/XXFB (XX - number of poles per row)	DWG NO.	ES1450/XXFB.DWG		
APPROVED		CHECKED		DESIGNED	
KSZ 2007.08.01	KSZ 2007.08.01	KSZ 2007.08.01	KSZ 2007.08.01	5020	
				Tolerance	
				UNIT: mm	.X ±015
				SCALE: NONE	.XX ±0.075
				REV: A	.XXX ±0.05
SHEET: 01/01					