

RECOMMENDED PCB LAYOUT

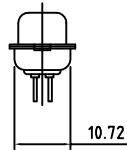
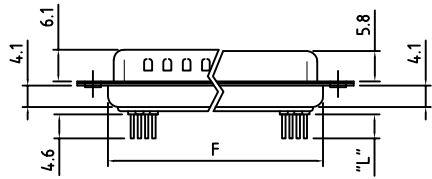

**MATERIAL**

Insulator: Glass Filled Thermoplastic UL94V-0  
 Contacts: Brass  
 Shell: Steel, 100u" Sn over 50u" min. Cu  
 Clinch Nut: Brass, Ni Plated  
 Board Lock: Brass, Sn Plated  
 Screwlock: Brass, Ni Plated

**ELECTRICAL**

Voltage Rating: 250V  
 Current Rating: 3 A  
 Contact Resistance: <20mΩ  
 Insulation Resistance: >1000 MΩ  
 Dielectric Withstanding Voltage: 1000 VAC/minute  
 Operating Temperature: -55C° ~ +85C°

RoHS Compliant

**Part Number**

**Mounting options**

- A-4-40 Jack screws assembled
  - B-Board Locks
  - C-Clinch Nuts (bottom side)
  - J-4-40 Jack Screws (bulk packed)
  - T-Threaded Inserts
- consult OST for other options, may require mins

DMS-XXXX-(see options)

POSITIONS

**PLATING**

- 1= Full Gold Flash/Nickel (STD)
  - 6= Selective Gold flash/Nickel
  - 7 = Selective 15u" Gold/Nickel
  - 8 = Selective 30u" Gold/Nickel
  - 9 = Selective 50u" Gold/Nickel
- NON-STD may require MOQ

**DIMENSION TABLE**

POSITIONS	A±0.15	B±0.10	C±0.15	D±0.13	E±0.08	F±0.10
09	30.81	24.99	16.92	16.33	11.08	19.20
15	39.14	33.32	25.50	24.66	19.39	27.70
25	53.04	47.04	38.96	38.38	33.24	41.10
37	69.32	63.50	55.42	54.84	49.86	57.30

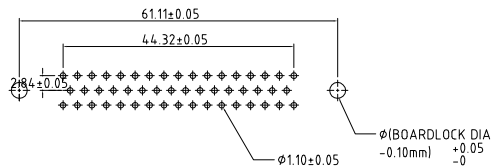
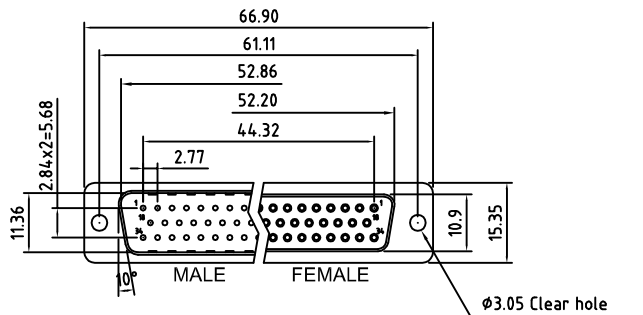

RECOMMENDED PCB LAYOUT

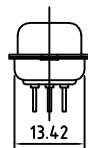
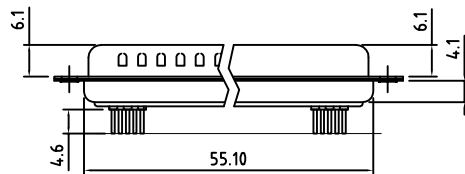

50 POSITIONS



TITLE		DMS Series - PCB Straight D-Sub Miniature				
PART NO.	DMS-XXXX	DWG NO.	DMS-XXXX.DWG			Tolerance
APPROVED	CHECKED	DESIGNED	DRAWN	2000		
Billy 2006.07.03	Johnn 2005.11.21	Tony 2005.11.21	Steven 2005.11.21			
				UNIT: mm	.X	±0.38
				SCALE: NONE	.XX	±0.25
				SHEET: 01/01	REV: A	.XXX
						±0.13

THESE DRAWINGS AND SPECIFICATIONS ARE THE PROPERTY OF ON-SHORE TECHNOLOGY, INC. AND SHALL NOT BE REPRODUCED, COPIED OR USED IN ANY MANNER WITHOUT THE PRIOR WRITTEN CONSENT OF ON-SHORE TECHNOLOGY, INC.