

Dimensions

Positions	A	B	D	E
15	30.81	24.99	16.33	2.29
26	39.14	33.32	24.66	2.29
44	53.04	47.04	38.38	2.29
62	69.32	63.50	54.84	2.41

P.C.B LAYOUT PATTERN

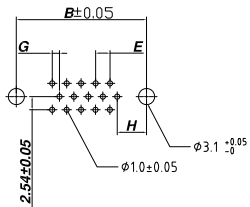

15 POSITION FEMALE

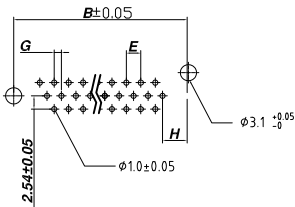

26,44,62 POSITION FEMALE

Positions	G	H
15M/F	1.145	7.04
26M/F	1.145	6.88
44M/F	1.145	6.88
62M/F	1.205	7.00

THESE DRAWINGS AND SPECIFICATIONS ARE THE PROPERTY OF ON-SHORE TECHNOLOGY, INC. AND SHALL NOT BE REPRODUCED, COPIED OR USED IN ANY MANNER WITHOUT THE PRIOR WRITTEN CONSENT OF ON-SHORE TECHNOLOGY, INC.

MATERIAL

Insulator: Glass Filled Thermoplastic UL94V-0, Black
 Contacts: Brass
 Shell: Steel, 100u" Sn over 50u" min. Cu

ELECTRICAL

Voltage Rating: 250 V AC(r.m.s.)
 Current Rating: 3 A
 Contact Resistance: <20mΩ
 Insulation Resistance: >5000 MΩ
 Dielectric Withstanding Voltage: 1000 VAC/minute
 Operating Temperature: -40°C ~ +105°C

RoHS Compliant

Options

- A-4-40 Jack screws assembled
- B-Board Locks
- F-Ferrite
- G-Grounding Straps
- J-4-40 Jack Screws (bulk packed)
- R-Riveted 4-40 Jack screws
- T-Threaded Inserts
- PB-Pantone Blue

Part Number

DMRH-XXSX-(see options)

Position

PLATING

- 6= Selective Gold flash/Nickel (STD)
- 7 = Selective 15u" Gold/Nickel
- 8 = Selective 30u" Gold/Nickel
- NON-STD may require MOQ



TITLE		DMRH Series - High Density Female D-Sub											
PART NO.	DMRH-XXSX-XXXX	DWG NO.	DMRH-XXSX-XXXX.DWG										
APPROVED	CHECKED	DESIGNED	DRAWN	4050 Tolerance									
Billy 2006.07.03	Johnn 2006.07.03	Tony 2006.07.03	Steven 2006.07.03	<table border="1"> <tr> <td>UNIT: mm/Inches</td> <td>.X</td> <td>±0.38</td> </tr> <tr> <td>SCALE: NONE</td> <td>.XX</td> <td>±0.25</td> </tr> <tr> <td></td> <td>.XXX</td> <td>±0.13</td> </tr> </table>	UNIT: mm/Inches	.X	±0.38	SCALE: NONE	.XX	±0.25		.XXX	±0.13
UNIT: mm/Inches	.X	±0.38											
SCALE: NONE	.XX	±0.25											
	.XXX	±0.13											
SHEET: 01/01				REV.: A									