

SIGN	DATE	DESCRIPTION	APPROVER
		THIS IS CAD DRAWING, DO NOT REVISE MANUALLY!!!	

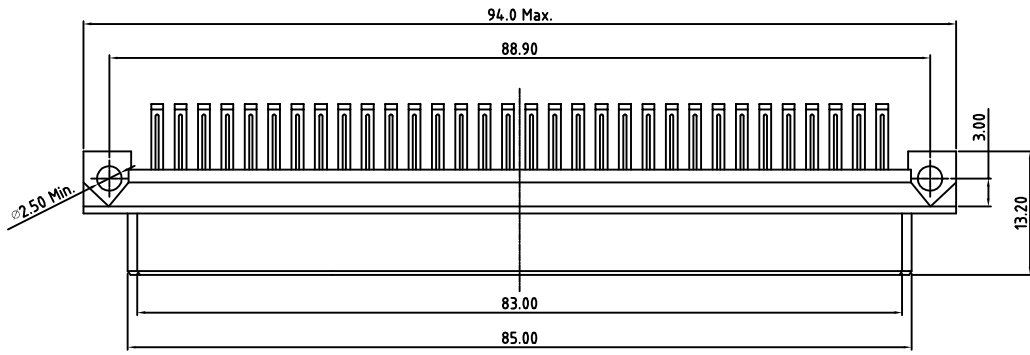

	a b c	96	2.54mm
	a - c	64	
Contact Arrangement	Row with Contacts	Position	Pitch

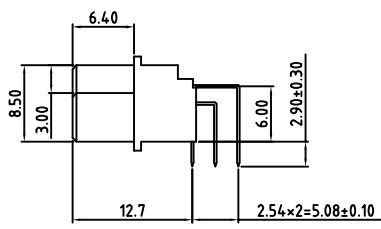
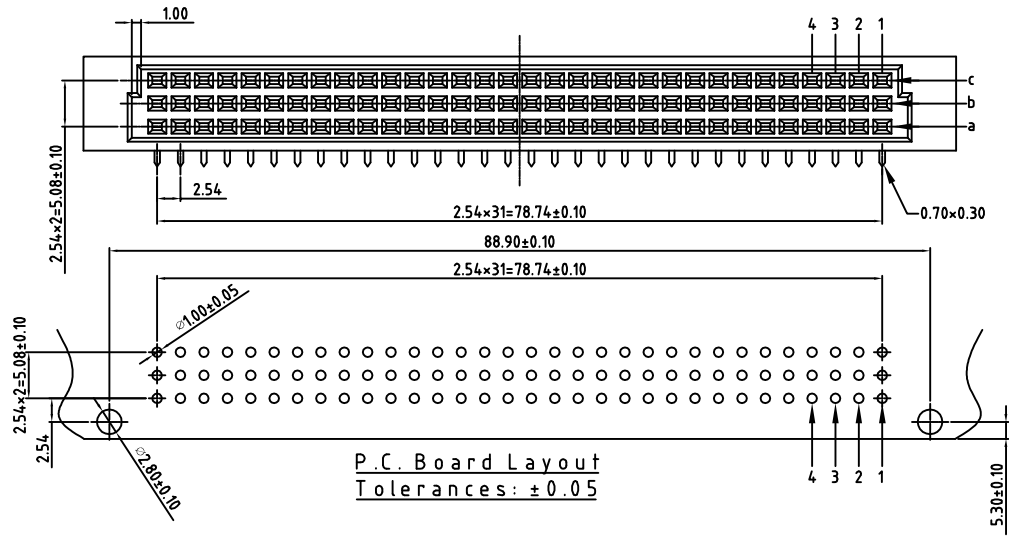

**Material:**  
Housing: 30% Glass Filled PBT UL94V-0  
Contacts: Phosphor Bronze  
Plating: Selective Flash Gold

**Electrical Characteristics:**  
Current Rating: 2A  
Dielectric Withstanding Voltage: AC 1000V For 1 minute  
Insulator Resistance: 1000M $\Omega$  max. at DC 500V  
Contact Resistance: 30M $\Omega$  max. at DC 100mA  
Operating Temperature: -55°C~+105°C

ROHS Compliant

THESE DRAWINGS AND SPECIFICATIONS ARE THE PROPERTY OF ON-SHORE TECHNOLOGY, INC. AND SHALL NOT BE REPRODUCED, COPIED OR USED IN ANY MANNER WITHOUT THE PRIOR WRITTEN CONSENT OF ON-SHORE TECHNOLOGY, INC.

**OST** ON-SHORE TECHNOLOGY, INC.

TITLE	DIN 41612, Type R, Female, Full			DWG NO. DINC-FXXS6.DWG	
PART NO.	DINR-FXXS6 (replace XX with contacts)			CUST NO. 1200	
APPROVED	CHECKED	DESIGNED	DRAWN		Tolerance
Yumi 2009.04.27	Yumi 2009.04.27	Yumi 2009.04.27	Yumi 2009.04.27		UNIT: mm
				SCALE: NONE	X.X $\pm 0.25$
				SHEET: 01/01	X.XX $\pm 0.15$
				REV: A	