

Specifications:

Current Rating: 3.0A AC/DC
 Voltage Rating: 250V AC/DC
 Contact Resistance: 20m Ohm Max
 Insulation Resistance: 1000M Ohm Min.
 Withstanding Voltage: 1000V AC/Minute
 Operating Temperature Range: -40°C To +105°C

Material and Finish:

Insulator: Thermoplastic (UL94V-0)
 Insulator Color: Beige
 Contact: Copper Alloy
 Plating: Gold/Bright Tin Plated

How To Order
 2600-XX-SXX

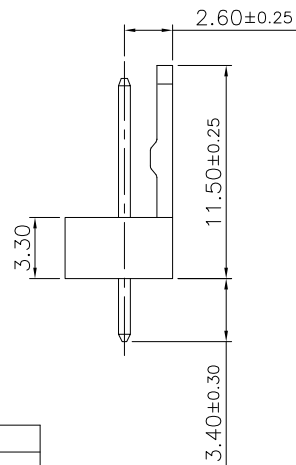
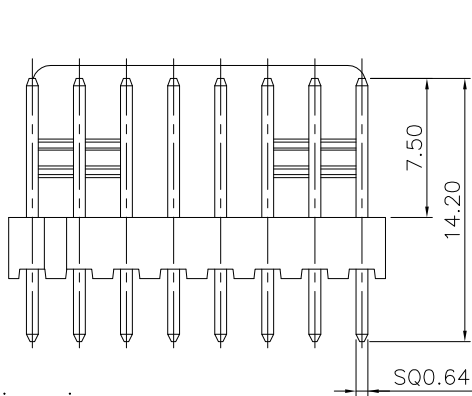

Dimension:

Circuits	Dimension:		Circuits	Dimension:	
	A	B		A	B
02	2.54	5.08	12	27.94	30.48
03	5.08	7.62	13	30.48	33.02
04	7.62	10.16	14	33.02	35.56
05	10.16	12.70	15	35.56	38.10
06	12.70	15.24	16	38.10	40.64
07	15.24	17.78	17	40.64	43.18
08	17.78	20.32	18	43.18	45.72
09	20.32	22.86	19	45.72	48.26
10	22.86	25.40	20	48.26	50.80
11	25.40	27.94			

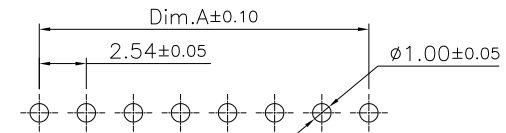

P.C.B Layout

RoHS Compliant

F				DRAWN:	GENERAL TOLERANCE:	OST	ON-SHORE TECHNOLOGY, INC.
E				Jamie Chuang	.X=±0.20 .XX=±0.15		
D				CHECKED:	UNIT: MM	DESCRIPTION:	SIZE
C				Jerry Chen	SCALE: 1:1		
B				APPROVAL:	SHEET: 1/2	PART NO:	2600-XX-S
A	08-Sep-2023		Jamie	Rory Chen	PROJECTION:		
REV	DATE	FILE	BY				