

1

2

3

4

5

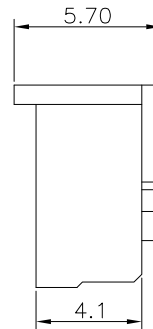
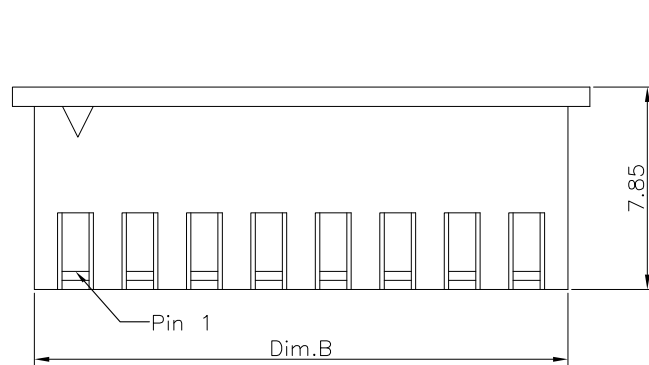
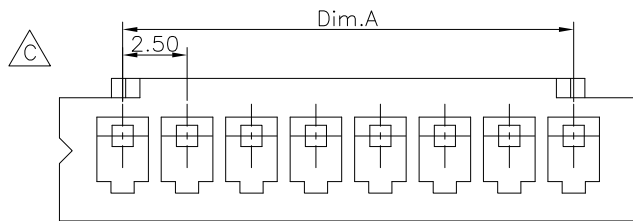

## Specifications:

Current Rating: 3.0A AC,DC

Voltage Rating: 250V AC,DC

Contact Resistance: 10m ohm.Max

Insulation Resistance: 1000M ohm.Min

Withstanding Voltage: 800V AC/Minute

Operating Temperature Range: -25°C ~ +85°C

## Material And Finish:

Insulator: Nylon 66 (UL94V-0)

Mating terminal: 250C2T-XX

## How To Order

250C2XX

No. Of Contacts

Pin.No	Dim.A	Dim.B	Pin.NO	Dim.A	Dim.B
2	2.50	5.70	10	22.50	25.70
3	5.00	8.20	11	25.00	28.20
4	7.50	10.70	12	27.50	30.70
5	10.00	13.20	13	30.00	33.20
6	12.50	15.70	14	32.50	35.70
7	15.00	18.20	15	35.00	38.20
8	17.50	20.70	16	37.50	40.70
9	20.00	23.20	20	47.50	50.70

RoHS Compliant

F				DRAWN:	GENERAL TOLERANCE:	 ON-SHORE TECHNOLOGY, INC.	DESCRIPTION: 2.50mm Wire To Board Housing SIZE
E			EISEN	.X=±0.30 .XX=±0.20			
D			CHECKED:	UNIT: MM			
C	01-JUL-2022	Update Drawing	BEN	DENNIS	SCALE: 1:1		
B	20-JAN-2022	Update DWG	MEI	APPROVAL:	SHEET: 1/1		
A	01-SEP-2014		EISEN	MIKE	PROJECTION:	PART NO: 250C2XX	
REV	DATE	FILE	BY				