

SIGN	DATE	DESCRIPTION	APPROVER
△			
△			
△			

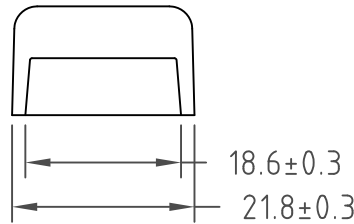
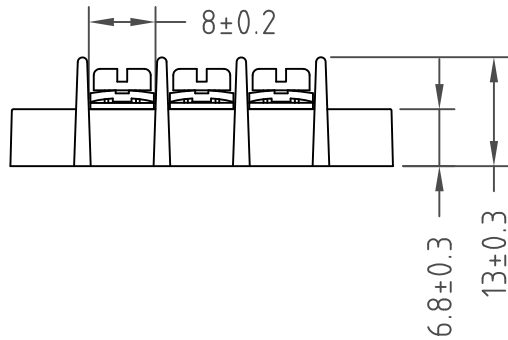
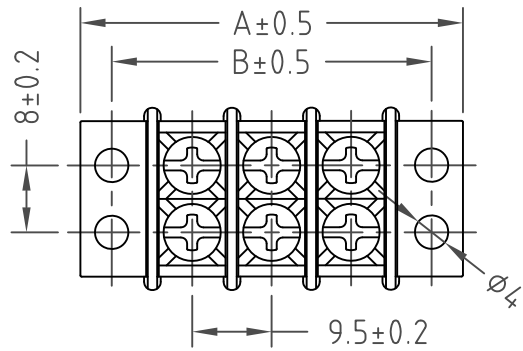

Technical Data:

Insulating body: PBT(UL94V-0)
 Terminal: Brass Tin plated
 Screw: Steel Zinc+Cr⁺³
 Voltage rating: 300VAC
 Current rating: 20 Amps
 Insulation withstand voltage: AC2000V min
 Insulation resistance: >5000MΩ DC500V
 Operating temperature: -40°C to +120°C
 Wire range: 12-22AWG
 Screw torque: 12lb-inch.
 Approvals: US

RoHS Compliant

Pitch: 9.5mm (0.374inch)

Poles	A	B	Poles	A	B
02	36.2	28.7	15	159.7	152.2
03	45.7	38.2	16	169.2	161.7
04	55.2	47.7	17	178.7	171.2
05	64.7	57.2	18	188.2	180.7
06	74.2	66.7	19	197.7	190.2
07	83.7	76.2	20	207.2	199.7
08	93.2	85.7	21	216.7	209.2
09	102.7	95.2	22	226.2	218.7
10	112.2	104.7	23	235.7	228.2
11	121.7	114.2	24	245.2	237.7
12	131.2	123.7	25	254.7	247.2
13	140.7	133.2			
14	150.2	142.7			

THESE DRAWINGS AND SPECIFICATIONS ARE THE PROPERTY OF ON-SHORE TECHNOLOGY, INC. AND SHALL NOT BE REPRODUCED, COPIED OR USED IN ANY MANNER WITHOUT THE PRIOR WRITTEN CONSENT OF ON-SHORE TECHNOLOGY, INC.

ON-SHORE TECHNOLOGY, INC.

PART. NAME: DB-95 DOUBLE ROW BARRIER STRIP 9.5mm PITCH

PART. NO.: DB-95MNW-XX (XX DENOTES NUMBER OF POSITIONS) DWG NAME: DB-95MNW-XX.DWG

APPROVED BY	CHECKED BY	DESIGNED BY	DRAWN BY	CUSTOM NO.:	Tolerance
		Shi Jun 2002.9.23	Shi Jun 2002.9.23	 UNITS: mm SCALE: NONE REVISION: A	