

Series: DP

Dual Port Right Angle D-Sub

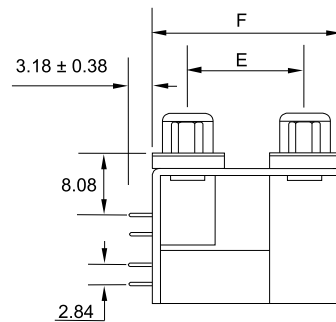
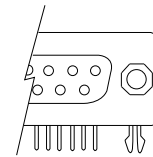
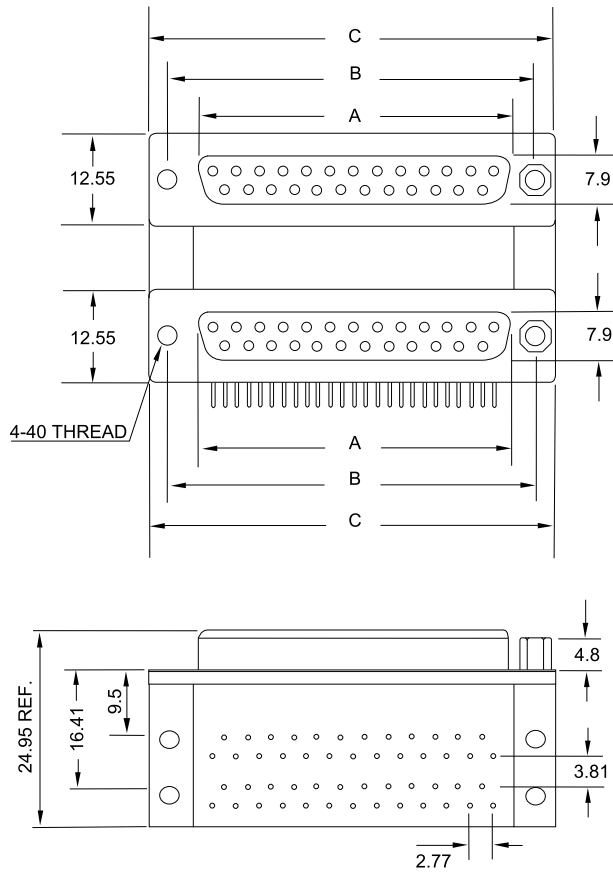
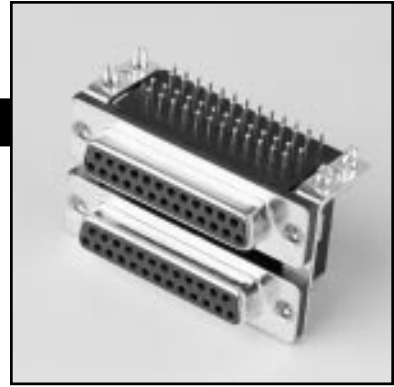

Ordering example: DP - 25S 25S 1 B - BJT

Positions	A	B	C
09	16.33	24.99	30.81
15	24.66	33.32	39.14
25	38.30	47.04	53.04
37	54.84	63.50	69.32

Spacings	E	F
A	15.88	28.42
B	19.05	31.60
C	22.86	35.41

Specifications

Dual Port Right Angle Stacked D-Sub Connector Series:

DP

Ratings:

Current	5A
Dielectric strength	AC 1000V for 1 minute
Contact resistance	30mΩ max. at DC 100mA
Insulator resistance	1000MΩ min. at DC 500V

Material:

Plastic	PBT Glass-filled, UL94V-0
Color	Black
Contact	Brass or Phosphor Bronze
Shell	Tin
Temperature	-55°C / +105°C, 260°C for 5 sec. (solder bath resistant)

ORDERING PROCEDURE

1 - 2 3 4 5 - 6

1) Series

2) Number of Positions (see chart for available positions)

Gender:

P = Male
S = Female

3) Number of Positions (see chart for available positions)

Gender:

P = Male
S = Female

4) Plating:

1 = Full Flash Gold
6 = Selective Flash Gold
7 = Selective 10μ Gold*
8 = Selective 30μ Gold*
* May Require Minimums

5) Spacing:

A = 15.88
B = 19.05
C = 22.86

6) Options:

A = 4-40 Jack screws assembled on connector
B = Board locks
G = Grounding straps
J = 4-40 Jack screws (bulk packed)
T = Threaded inserts

Please refer to following page for ordering example.