

SIGN	DATE	DESCRIPTION	APPROVER
		<i>THIS IS CAD DRAWING, DO NOT REVISE MANUALLY!!!</i>	

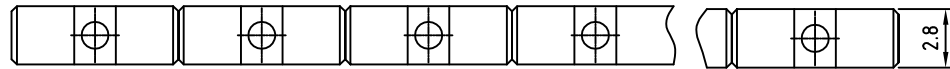

N = Number of contact

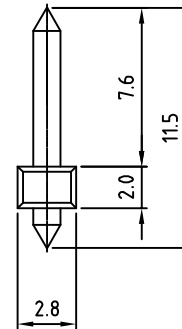
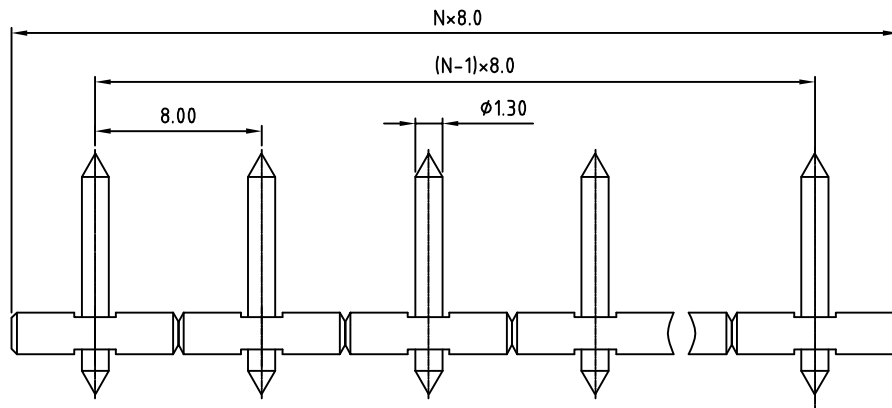

Material

- Solid PIN: Brass(CuZn)
- Surface of solder tail: Tin or Au plated.
- Insulator (housing): Thermoplastic (UL94V-0)

Electrical cULus

- Voltage rating: 300V
- Current rating: 10A
- Withstanding Voltage: 1.6KV
- Operating temperature: -30°C to +105°C
- Soldering temperature: 250°C±10°C/5 Sec

RoHS Compliant

PART NUMBER:

OSTOPXX6300

- No. of Poles
 02: 2 Poles
 03: 3 Poles

 20: 20 Poles

THESE DRAWINGS AND SPECIFICATIONS ARE THE PROPERTY OF ON-SHORE TECHNOLOGY, INC. AND SHALL NOT BE REPRODUCED, COPIED OR USED IN ANY MANNER WITHOUT THE PRIOR WRITTEN CONSENT OF ON-SHORE TECHNOLOGY, INC.

P.C.B LAYOUT

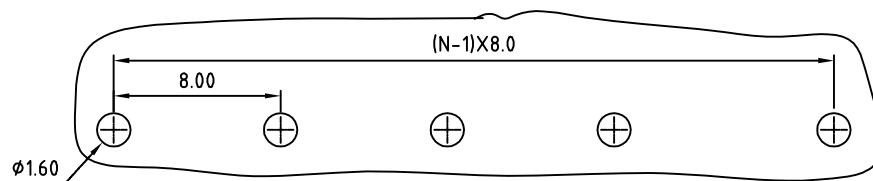

TITLE		OSTOP-8.0mm series 2p-20p			
PART NO.		OSTOPXX6300		DWG NO.	OSTOPXX6300.DWG
APPROVED	CHECKED	DESIGNED	DRAWN	CUST NO.	Tolerance
Shi Jun 2006.10.30	Marvin 2006.10.30	Marvin 2006.10.30	Marvin 2006.10.30		X. ±0.50
					X.X ±0.30
					X.XX ±0.10
					X° ±1°
				SHEET: 01/01	REV: C